

Installation Instructions



2004 Yield-Pro® Planter Seed Tube Support Update

Used with:

- 2004 Yield-Pro® Planter



When you see this symbol, the subsequent instructions and warnings are serious - follow without exception. Your life and the lives of others depend on it!

General Information

These instructions explain how to install the 2004 Yield-Pro® Seed Tube Support Update. This kit is designed to prevent and resolve problems with hoses and/or seed flow. These instructions apply to:

403-213A Seed Tube Support Update

Before You Start

Page 6 is a detailed listing of parts included in the Seed Tube Support Update. Use this list to inventory parts received.

Tools Required

- Basic Hand Tools

Assembly Instructions

Refer to Figure 1

NOTE: To install seed tube support update, planter must be completely folded up. For safety purposes, please install all transport locks before installing update kit.

1. Unscrew and remove swivel hose guard assembly from both right-hand and left-hand side of the planter.
2. Detach y-tubes from swivel hose guard assembly.
3. Save y-tubes for reuse.

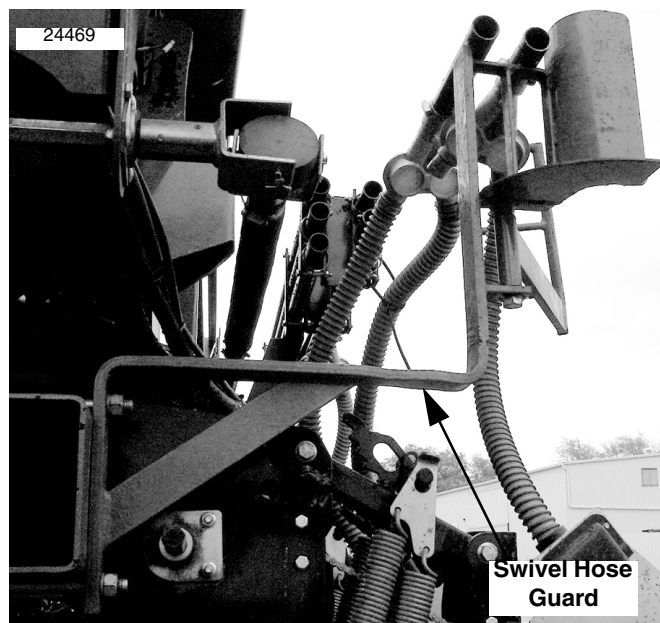

Figure 1

Remove Swivel Hose Guard Assembly

2 | Seed Tube Support Update

Refer to Figure 2

4. Unscrew and remove hose support bar (1) from planter frame.
5. Detach rear hose support mount (2) from fan guard (7) and light bracket (6) by unscrewing 1/2-13 x 5 bolt (5) and 1/2-13 x 3 1/2 bolt (4). Discard rear hose support mount (2).
6. Reattach light bracket (6) to fan guard (7) using 1/2-13 x 5 bolt (5), 1/2-13 nut hex (3).
7. Complete steps on opposite side of planter.

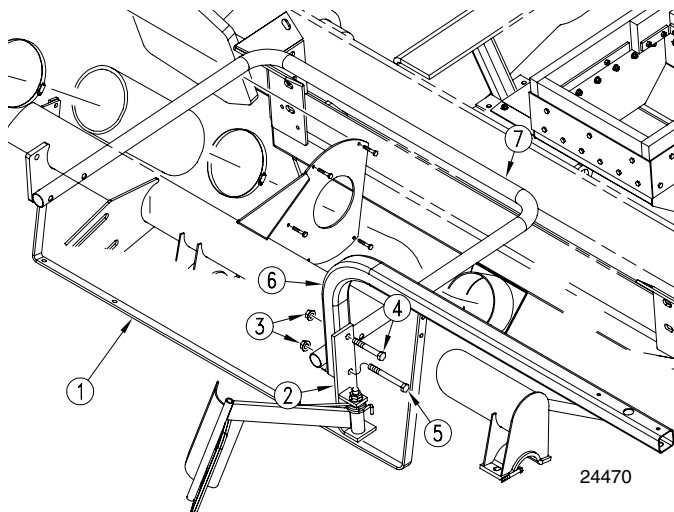

Figure 2

Hose Support Bar & Rear Hose Support Mount

Refer to Figure 3

8. Unclamp and remove air hoses from end of seed tubes. Keep hose clamps for reuse.
9. Remove last set of air tube support clamps (3) closest to center of planter frame by unscrewing bolts (2) and discarding all hardware.
10. Measure 12" off the end of the air tubes (1) closest to the center of planter. Cut measured 12" off end of air tubes (1).

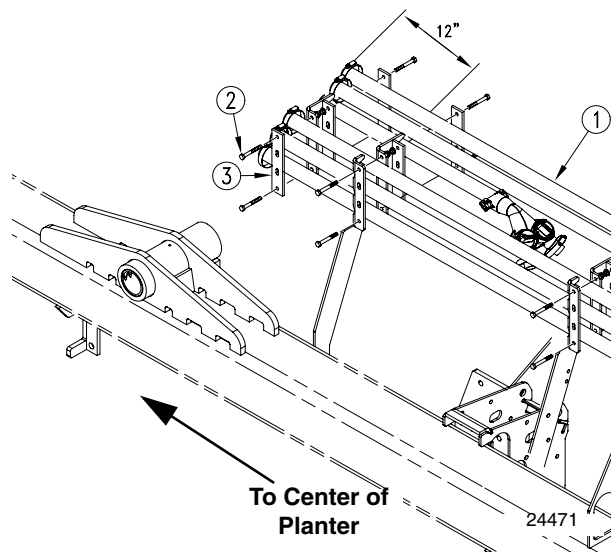

Figure 3

Air Tubes

Refer to Figure 4

11. The toolbar air hose support comes in a pair of left-hand and right-hand. Toolbar air hose support will not install if trying to install LH toolbar air hose support on RH planter toolbar channel.

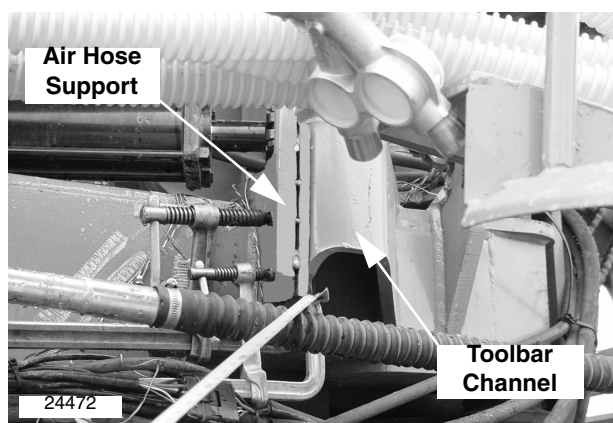

Figure 4

Toolbar Air Hose Support

Refer to Figure 5

12. Align air hose support weldment with toolbar channel as shown in Figure 5.
13. Once air hose support is aligned with toolbar channel, clamp support weldment to channel.
14. Secure air hose support weldment to toolbar channel by welding support to channel - or drill out holes in toolbar channel that match up with holes in air hose support and secure with 5/8-11 x 2 bolts, 5/8 lock washers, and 5/8-11 hex nuts.
15. Attach opposite air hose support weldment to opposite side of planter.

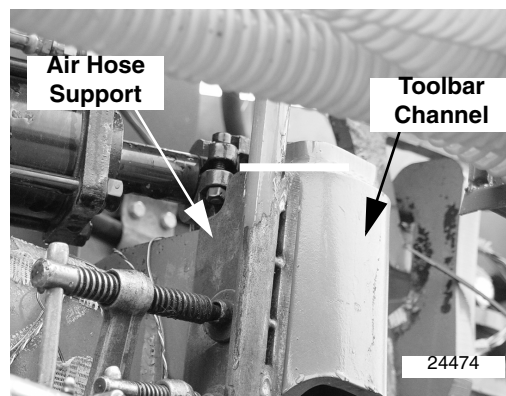

Figure 5
Alignment

Refer to Figure 6

16. Attach seed tube bracket to frame location shown in Figure 6.

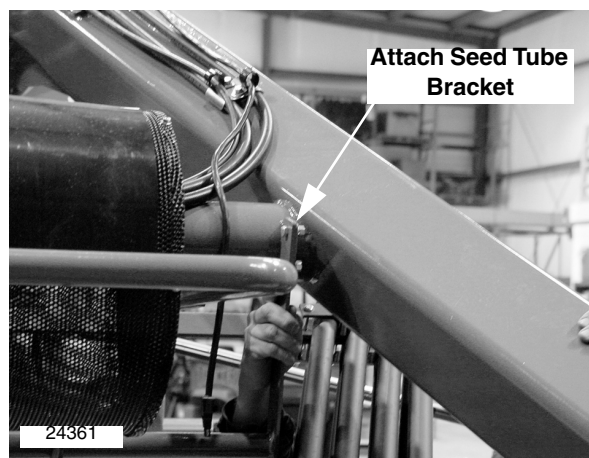

Figure 6
Attachment Location

Refer to Figure 7

17. Secure seed tube support bracket to planter frame using 3/8-16 x 1 1/4 bolts, 3/8 lock washers, and 3/8-16 hex nuts.



Figure 7
Secure Seed Tube Bracket

4 | Seed Tube Support Update

Refer to Figure 8

18. To attach air hoses from manifold box to seed tubes located on the seed tube bracket, use the chart on the right.

****Viewed as looking at front side of manifold box sitting in front of box and looking to rear.**

****I.E. Outlet 1 feeds left end of planter.**

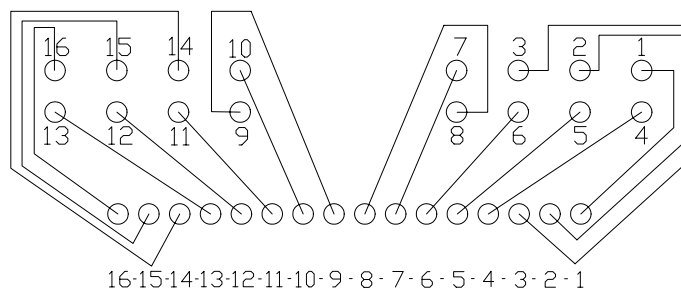

Figure 8

24475

Hose Routing Between Manifold and Seed Tubes

Refer to Figure 9

19. Leaving air hoses attached to manifold box, start with outlet 1, shown in the chart, and pull air hose tightly toward corresponding seed tube.
20. Approximate amount of air hose needed to connect manifold box to seed tube. Cut air hose at approximated distance. Keep all air hose for reuse.
21. Clamp air hose to corresponding seed tube. Continue for all air hoses.



Figure 9

Attach Air Hose to Seed Tubes

Refer to Figure 10

22. Attach remaining air hoses to seed tubes located on the seed tube bracket. Secure hoses to tubes using clamps.
23. Pulling tightly, guide hoses through air hose support on planter toolbar.

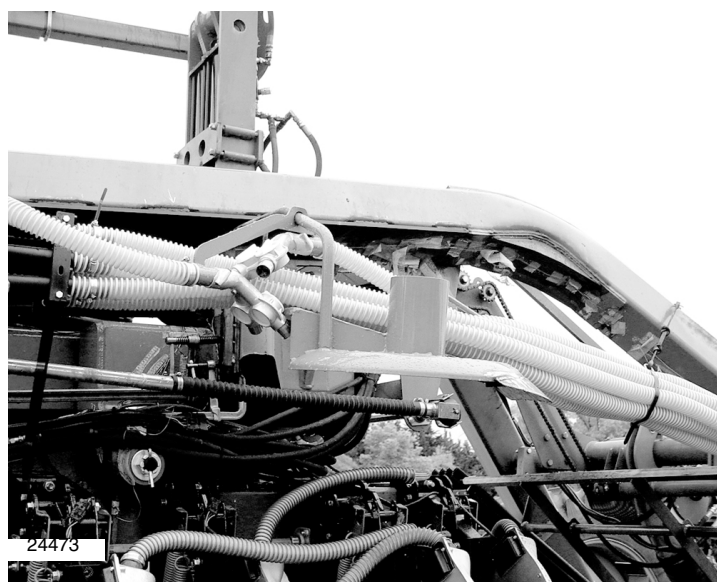
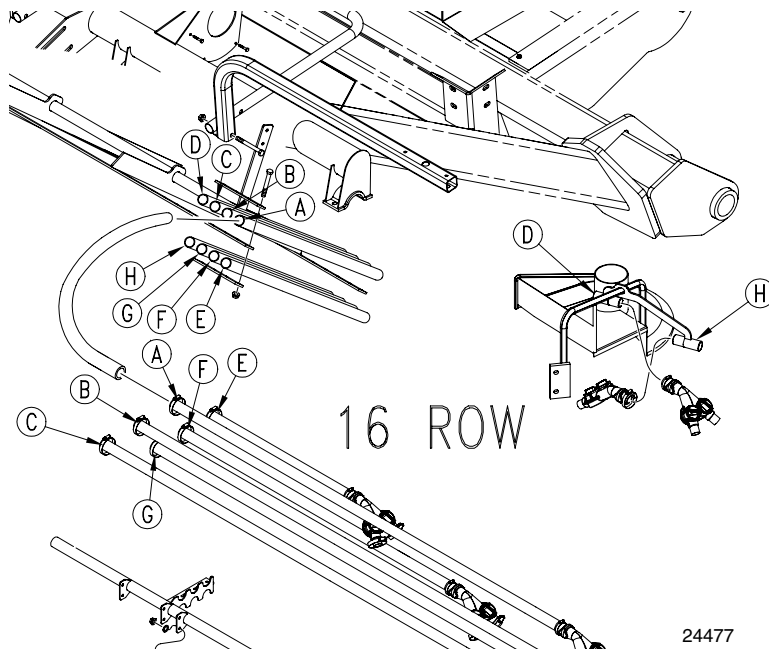

Figure 10

Air Hose Support

Refer to Figure 11

24. Connect each seed tube located on the seed tube bracket with corresponding seed tube located on each planter wing frame. Refer to diagram to the right for corresponding seed tubes.
25. Use previously removed clamps to secure air hoses to seed tubes located on planter wing frame.
26. Complete for all seed tubes on both sides of planter.
27. Attach previously removed y-tubes to air hoses D and H.

**Figure 11****Air Hose Routing****Refer to Figure 12**

28. Use 1 large cable tie to loosely hold the 1 1/2" airhoses together. It must be loose enough to let them slide against each other. Use 1 smaller tie to secure the large tie in place by hooking it to one, 1 1/2" hose.

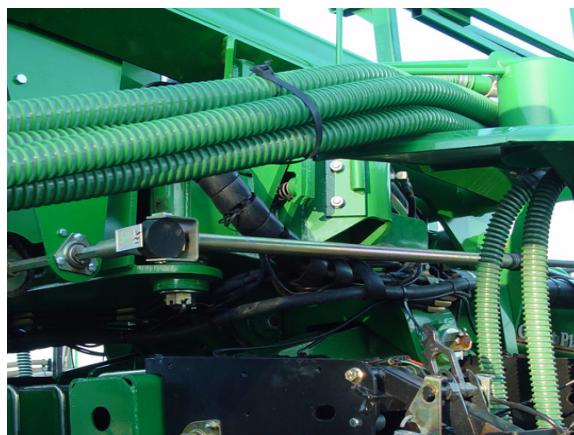
**Figure 12****Cable Tie Air Hoses****Refer to Figure 13**

29. Use 1 small cable tie to secure the air hose denoted as H in Figure 11 to another air hose.
- NOTE: This prevents the air hose from malfunctioning or being damaged.**

**Figure 13****Cable Tie Air Hose H**

403-213A Seed Tube Support Update

Your kit includes:

Qty.	Part No.	Part Description
1	403-171H	SEED TUBE SUPPORT BKT WLDMNT
8	403-278D	AIR TUBE RETAINER STRAP
4	800-082C	CABLE TIE .31X21.5 6DIA 120LB
32	800-124C	CLAMP WRM DRV #24 SS (1.06 - 2)
2	800-269C	CABLE TIE 33LG
4	802-055C	HHCS 5/8-11 X 2 GR5
4	802-079C	HHCS 3/8-16 X 1 1/4 GR5
20	802-474C	HHCS 5/16-18 X 4 1/2 GR5
4	803-014C	NUT HEX 3/8-16 PLT
4	803-021C	NUT HEX 5/8-11 PLT
20	803-084C	NUT HEX NYLOCK 5/16-18
4	804-013C	WASHER LOCK SPRING 3/8 PLT
4	804-022C	WASHER LOCK SPRING 5/8 PLT
16	817-617C	SEED DELIVERY TUBE 60
1	403-211H	LH TOOLBAR AIR HOSE SUPPORT
1	403-212H	RH TOOLBAR AIR HOSE SUPPORT
1	403-210M	MANUAL SEED TUBE SUPPORT